

LEGENDA
 --- RECINZIONE
 --- DEMOLIZIONI

COMMITTENTE:
RFI
 R.F. INFRASTRUTTURE FERROVIARIE
 GRUPPO FERROVIE DELLO STATO

PROGETTAZIONE:
ITALFER
 GRUPPO FERROVIE DELLO STATO

U.O.: PROGETTAZIONE LINEE E NODI

PROGETTO PRELIMINARE
 NUOVA LINEA AV/AC VENEZIA - TRIESTE
 TRATTA RONCHI - TRIESTE
 Planimetria su cartografia Linea AV/AC
 dal Km 33+000 al Km 36+634,65
 Tav. 9/10

SCALA:
 1:5.000

COMMESSA LOTTO FASE ENTE TIPO DOC. OPERA/DESCRIZIONE PROG. REV.
 L344 00 R 13 P5 IF0001 009 A

| Rev. | Descrizione | Realizzato | Data | Verificato | Data | Approvato | Data | Autore | Data |
|------|---------------------|------------|------|------------|------|-----------|------|--------|------|
| A | Emissione esecutiva | | | | | | | | |

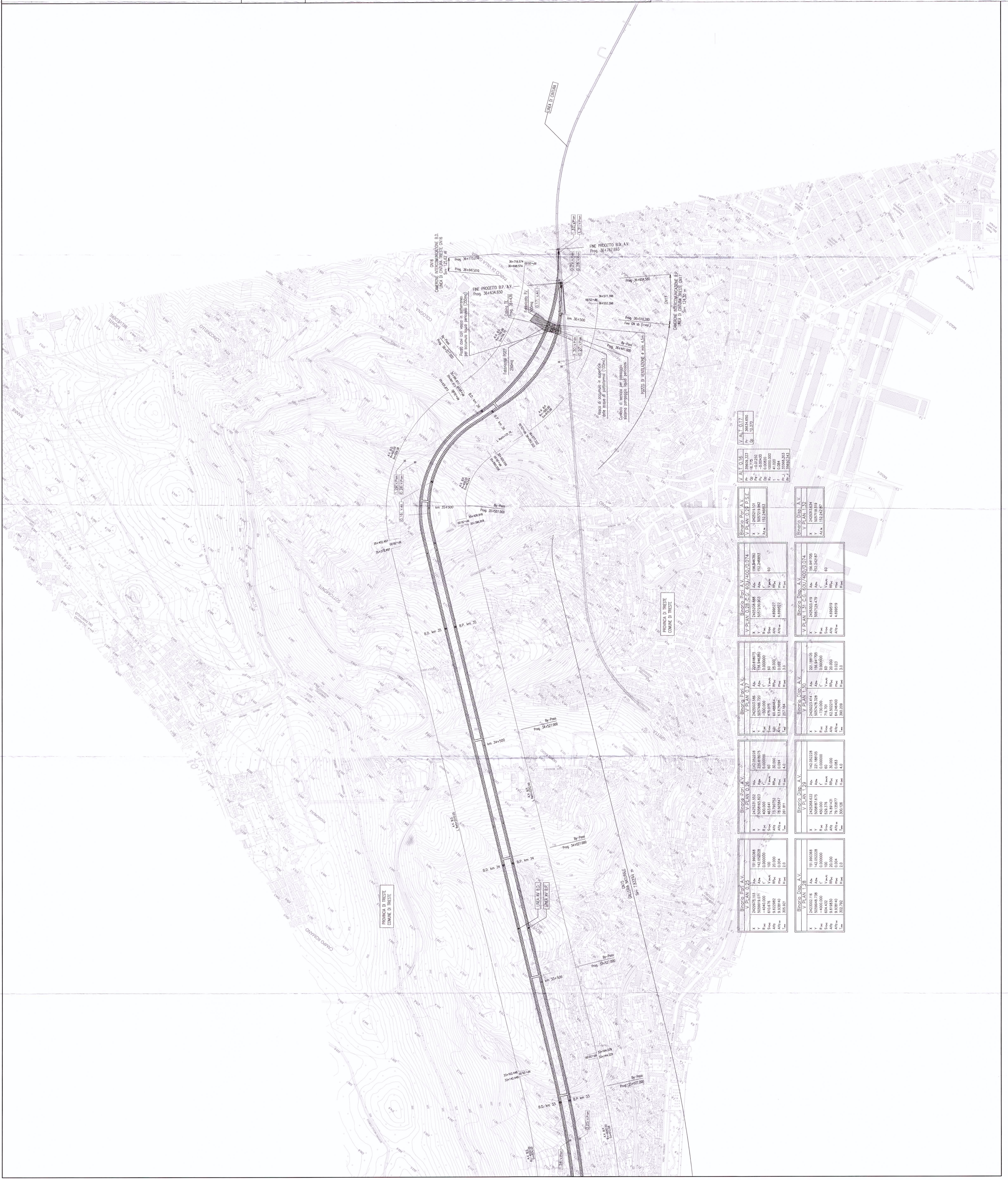

| Binomio Prof. A.V. | | Binomio Disp. A.V. | |
|--------------------|---------|--------------------|-------------|
| V. PLAN | V. PLAN | X | Y |
| 0.25 | 0.26 | 2425002.118 | 4900000.000 |
| 0.26 | 0.27 | 2425002.118 | 4900000.000 |
| 0.27 | 0.28 | 2425002.118 | 4900000.000 |
| 0.28 | 0.29 | 2425002.118 | 4900000.000 |
| 0.29 | 0.30 | 2425002.118 | 4900000.000 |
| 0.30 | 0.31 | 2425002.118 | 4900000.000 |
| 0.31 | 0.32 | 2425002.118 | 4900000.000 |
| 0.32 | 0.33 | 2425002.118 | 4900000.000 |
| 0.33 | 0.34 | 2425002.118 | 4900000.000 |
| 0.34 | 0.35 | 2425002.118 | 4900000.000 |
| 0.35 | 0.36 | 2425002.118 | 4900000.000 |
| 0.36 | 0.37 | 2425002.118 | 4900000.000 |
| 0.37 | 0.38 | 2425002.118 | 4900000.000 |
| 0.38 | 0.39 | 2425002.118 | 4900000.000 |
| 0.39 | 0.40 | 2425002.118 | 4900000.000 |
| 0.40 | 0.41 | 2425002.118 | 4900000.000 |
| 0.41 | 0.42 | 2425002.118 | 4900000.000 |
| 0.42 | 0.43 | 2425002.118 | 4900000.000 |
| 0.43 | 0.44 | 2425002.118 | 4900000.000 |
| 0.44 | 0.45 | 2425002.118 | 4900000.000 |
| 0.45 | 0.46 | 2425002.118 | 4900000.000 |
| 0.46 | 0.47 | 2425002.118 | 4900000.000 |
| 0.47 | 0.48 | 2425002.118 | 4900000.000 |
| 0.48 | 0.49 | 2425002.118 | 4900000.000 |
| 0.49 | 0.50 | 2425002.118 | 4900000.000 |
| 0.50 | 0.51 | 2425002.118 | 4900000.000 |
| 0.51 | 0.52 | 2425002.118 | 4900000.000 |
| 0.52 | 0.53 | 2425002.118 | 4900000.000 |
| 0.53 | 0.54 | 2425002.118 | 4900000.000 |
| 0.54 | 0.55 | 2425002.118 | 4900000.000 |
| 0.55 | 0.56 | 2425002.118 | 4900000.000 |
| 0.56 | 0.57 | 2425002.118 | 4900000.000 |
| 0.57 | 0.58 | 2425002.118 | 4900000.000 |
| 0.58 | 0.59 | 2425002.118 | 4900000.000 |
| 0.59 | 0.60 | 2425002.118 | 4900000.000 |
| 0.60 | 0.61 | 2425002.118 | 4900000.000 |
| 0.61 | 0.62 | 2425002.118 | 4900000.000 |
| 0.62 | 0.63 | 2425002.118 | 4900000.000 |
| 0.63 | 0.64 | 2425002.118 | 4900000.000 |
| 0.64 | 0.65 | 2425002.118 | 4900000.000 |
| 0.65 | 0.66 | 2425002.118 | 4900000.000 |
| 0.66 | 0.67 | 2425002.118 | 4900000.000 |
| 0.67 | 0.68 | 2425002.118 | 4900000.000 |
| 0.68 | 0.69 | 2425002.118 | 4900000.000 |
| 0.69 | 0.70 | 2425002.118 | 4900000.000 |
| 0.70 | 0.71 | 2425002.118 | 4900000.000 |
| 0.71 | 0.72 | 2425002.118 | 4900000.000 |
| 0.72 | 0.73 | 2425002.118 | 4900000.000 |
| 0.73 | 0.74 | 2425002.118 | 4900000.000 |
| 0.74 | 0.75 | 2425002.118 | 4900000.000 |
| 0.75 | 0.76 | 2425002.118 | 4900000.000 |
| 0.76 | 0.77 | 2425002.118 | 4900000.000 |
| 0.77 | 0.78 | 2425002.118 | 4900000.000 |
| 0.78 | 0.79 | 2425002.118 | 4900000.000 |
| 0.79 | 0.80 | 2425002.118 | 4900000.000 |
| 0.80 | 0.81 | 2425002.118 | 4900000.000 |
| 0.81 | 0.82 | 2425002.118 | 4900000.000 |
| 0.82 | 0.83 | 2425002.118 | 4900000.000 |
| 0.83 | 0.84 | 2425002.118 | 4900000.000 |
| 0.84 | 0.85 | 2425002.118 | 4900000.000 |
| 0.85 | 0.86 | 2425002.118 | 4900000.000 |
| 0.86 | 0.87 | 2425002.118 | 4900000.000 |
| 0.87 | 0.88 | 2425002.118 | 4900000.000 |
| 0.88 | 0.89 | 2425002.118 | 4900000.000 |
| 0.89 | 0.90 | 2425002.118 | 4900000.000 |
| 0.90 | 0.91 | 2425002.118 | 4900000.000 |
| 0.91 | 0.92 | 2425002.118 | 4900000.000 |
| 0.92 | 0.93 | 2425002.118 | 4900000.000 |
| 0.93 | 0.94 | 2425002.118 | 4900000.000 |
| 0.94 | 0.95 | 2425002.118 | 4900000.000 |
| 0.95 | 0.96 | 2425002.118 | 4900000.000 |
| 0.96 | 0.97 | 2425002.118 | 4900000.000 |
| 0.97 | 0.98 | 2425002.118 | 4900000.000 |
| 0.98 | 0.99 | 2425002.118 | 4900000.000 |
| 0.99 | 1.00 | 2425002.118 | 4900000.000 |